

ORDERING INFORMATION					
PART NO.	AEC-Q101 QUALIFIED	PACKING CODE	GREEN COMPOUND CODE	PACKAGE	PACKING
ES2xA (Note 1)	Prefix "H"	R3	Suffix "G"	SMA	1,800 / 7" Plastic reel
		R2		SMA	7,500 / 13" Paper reel
		M2		SMA	7,500 / 13" Plastic reel
		F3		Folded SMA	1,800 / 7" Plastic reel
		F2		Folded SMA	7,500 / 13" Paper reel
		F4		Folded SMA	7,500 / 13" Plastic reel
	N/A	E3		Clip SMA	1,800 / 7" Plastic reel
		E2		Clip SMA	7,500 / 13" Plastic reel

Note 1: "xx" defines voltage from 50V (ES2AA) to 600V (ES2JA)

EXAMPLE					
PREFERRED P/N	PART NO.	AEC-Q101 QUALIFIED	PACKING CODE	GREEN COMPOUND CODE	DESCRIPTION
ES2JA R3	ES2JA		R3		
ES2JA R3G	ES2JA		R3	G	Green compound
ES2JAHR3	ES2JA	H	R3		AEC-Q101 qualified

RATINGS AND CHARACTERISTICS CURVES

(TA=25°C unless otherwise noted)

FIG. 1 MAXIMUM FORWARD CURRENT DERATING CURVE

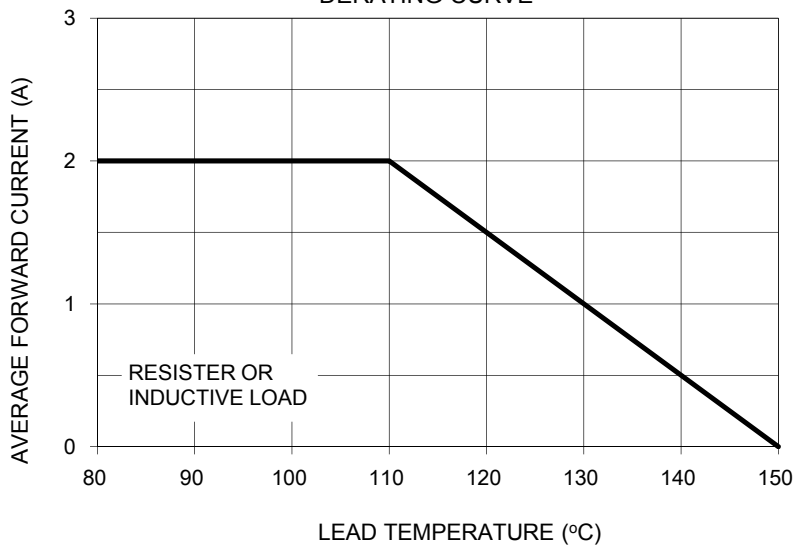

FIG. 2 TYPICAL REVERSE CHARACTERISTICS

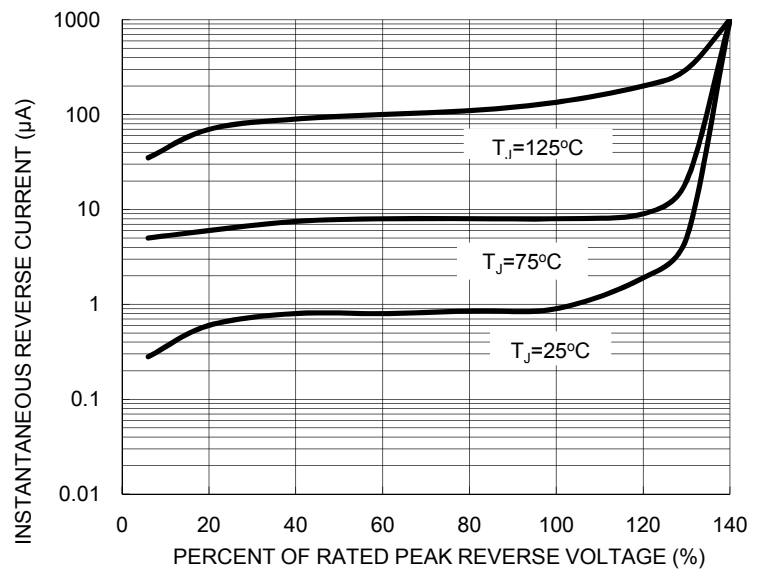

FIG. 3 MAXIMUM NON-REPETITIVE PEAK FORWARD SURGE CURRENT

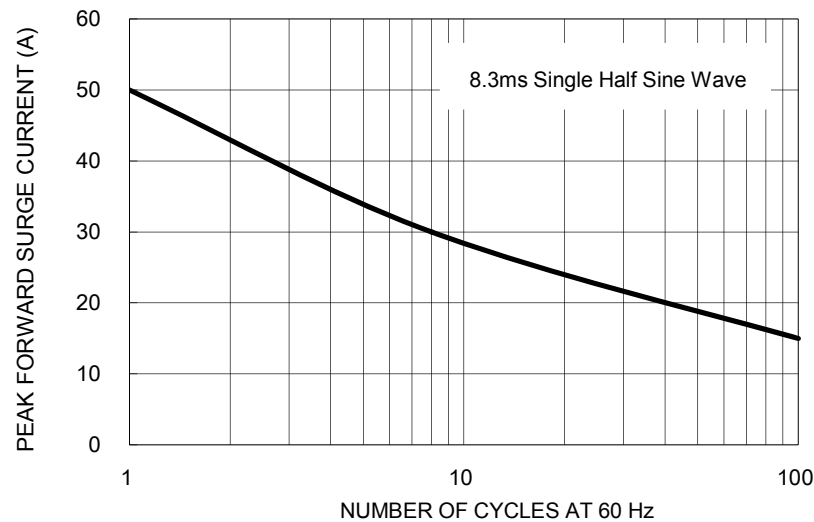

FIG. 4 TYPICAL INSTANTANEOUS FORWARD CHARACTERISTICS

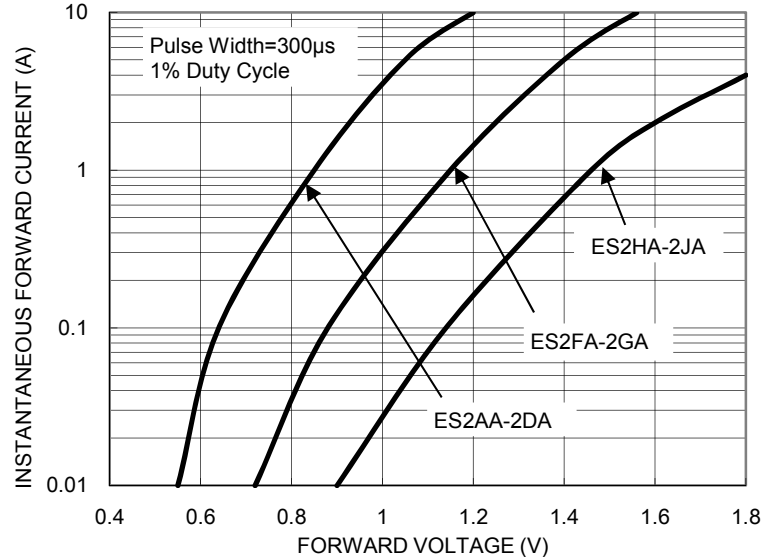

FIG. 5 TYPICAL JUNCTION CAPACITANCE

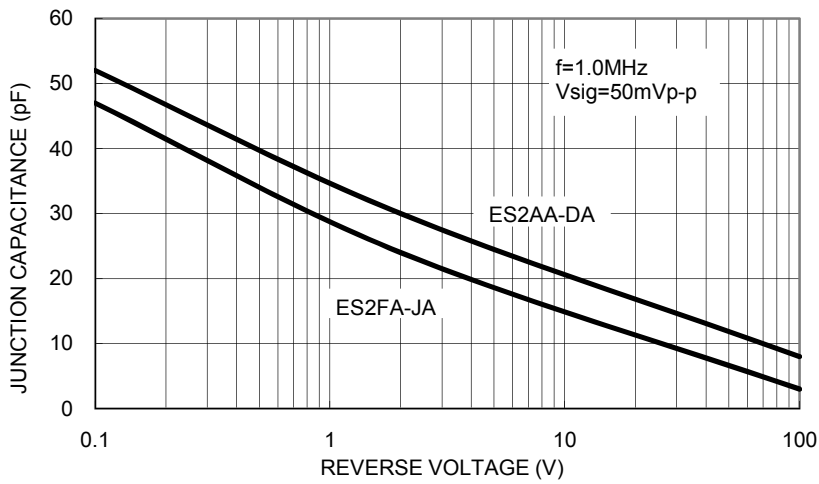
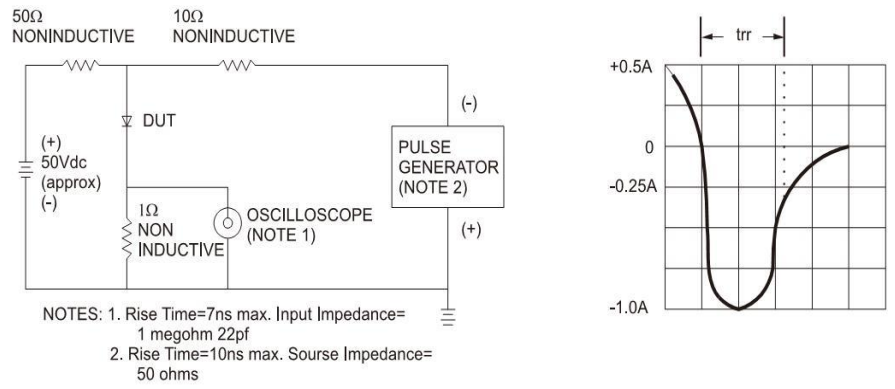
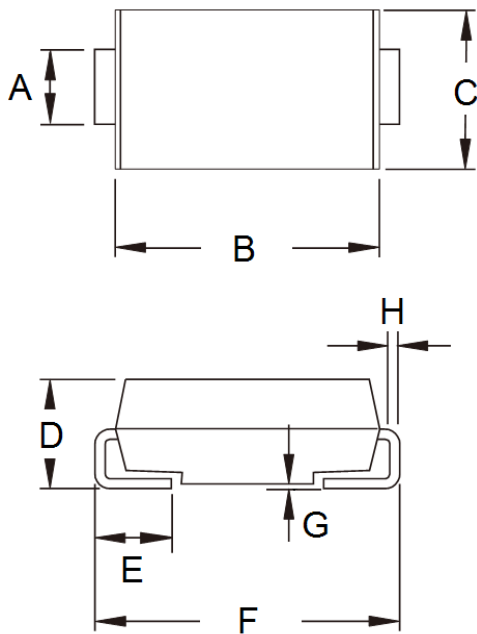

FIG.6- REVERSE RECOVERY TIME CHARACTERISTIC AND TEST CIRCUIT DIAGRAM



PACKAGE OUTLINE DIMENSIONS
DO-214AC (SMA)



DIM.	Unit (mm)		Unit (inch)	
	Min	Max	Min	Max
A	1.27	1.58	0.050	0.062
B	4.06	4.60	0.160	0.181
C	2.29	2.83	0.090	0.111
D	1.99	2.50	0.078	0.098
E	0.90	1.41	0.035	0.056
F	4.95	5.33	0.195	0.210
G	0.10	0.20	0.004	0.008
H	0.15	0.31	0.006	0.012

SUGGESTED PAD LAYOUT

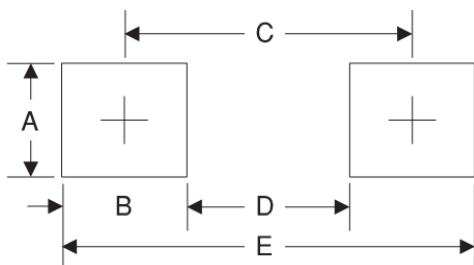

Symbol	Unit (mm)	Unit (inch)
A	1.68	0.066
B	1.52	0.060
C	3.93	0.155
D	2.41	0.095
E	5.45	0.215

MARKING DIAGRAM



- P/N = Specific Device Code
- G = Green Compound
- YW = Date Code
- F = Factory Code

Notice

Specifications of the products displayed herein are subject to change without notice. TSC or anyone on its behalf, assumes no responsibility or liability for any errors inaccuracies.

Information contained herein is intended to provide a product description only. No license, express or implied, to any intellectual property rights is granted by this document. Except as provided in TSC's terms and conditions of sale for such products, TSC assumes no liability whatsoever, and disclaims any express or implied warranty, relating to sale and/or use of TSC products including liability or warranties relating to fitness for a particular purpose, merchantability, or infringement of any patent, copyright, or other intellectual property right.

The products shown herein are not designed for use in medical, life-saving, or life-sustaining applications. Customers using or selling these products for use in such applications do so at their own risk and agree to fully indemnify TSC for any damages resulting from such improper use or sale.

Mouser Electronics

Authorized Distributor

Click to View Pricing, Inventory, Delivery & Lifecycle Information:

Taiwan Semiconductor:

[ES2DA R3G](#) [ES2CA F3G](#) [ES2GAHR2](#) [ES2BAHR2](#) [ES2DAHf3](#) [ES2GAHF2](#) [ES2GA R3G](#) [ES2AA F3G](#)
[ES2CAHR3](#) [ES2JAHF2](#) [ES2AA R3G](#) [ES2FA F3G](#) [ES2HAHF3](#) [ES2AAHR3](#) [ES2FAHR2](#) [ES2HAHR2](#) [ES2CAHF3](#)
[ES2JAHR2](#) [ES2AA R2G](#) [ES2BA R3G](#) [ES2AAHR2](#) [ES2GAHF3](#) [ES2AAHF3](#) [ES2HAHF2](#) [ES2GAHR3](#) [ES2HAHR3](#)
[ES2CAHR2](#) [ES2DAHR3](#) [ES2JA R3G](#) [ES2JA R2](#) [ES2BAHF2](#) [ES2JAHF3](#) [ES2FA R3G](#) [ES2DAHf2](#) [ES2HA F3G](#)
[ES2CA R3G](#) [ES2DA F3G](#) [ES2BAHR3](#) [ES2BAHF3](#) [ES2DAHR2](#) [ES2BA F3G](#) [ES2JA F3G](#) [ES2JAHR3](#) [ES2GA R2G](#)
[ES2HA R3G](#) [ES2FAHF2](#) [ES2GA F3G](#) [ES2AAHF2](#) [ES2CAHF2](#) [ES2FAHF3](#) [ES2JA F2](#) [ES2BA F3](#) [ES2FAHR3](#)
[ES2JA F3](#) [ES2DA F3](#) [ES2HA F3](#) [ES2FA F3](#) [ES2CA F3](#) [ES2AA F3](#) [ES2GA F3](#)