

CMMSH1-20 CMMSH1-20G\*  
 CMMSH1-40 CMMSH1-40G\*  
 CMMSH1-60 CMMSH1-60G\*  
 CMMSH1-100 CMMSH1-100G\*

**SURFACE MOUNT SILICON  
 SCHOTTKY RECTIFIER  
 1 AMP, 20 THRU 100 VOLTS**



**ELECTRICAL CHARACTERISTICS - Continued:** ( $T_A=25^\circ\text{C}$  unless otherwise noted)

SYMBOL	TEST CONDITIONS	TYP	UNITS
$C_J$	$V_R=4.0\text{V}$ , $f=1.0\text{MHz}$ (CMMSH1-20, -20G)	60	pF
$C_J$	$V_R=4.0\text{V}$ , $f=1.0\text{MHz}$ (CMMSH1-40, -40G)	60	pF
$C_J$	$V_R=4.0\text{V}$ , $f=1.0\text{MHz}$ (CMMSH1-60, -60G)	50	pF
$C_J$	$V_R=4.0\text{V}$ , $f=1.0\text{MHz}$ (CMMSH1-100, -100G)	40	pF

**SOD-123F CASE - MECHANICAL OUTLINE**

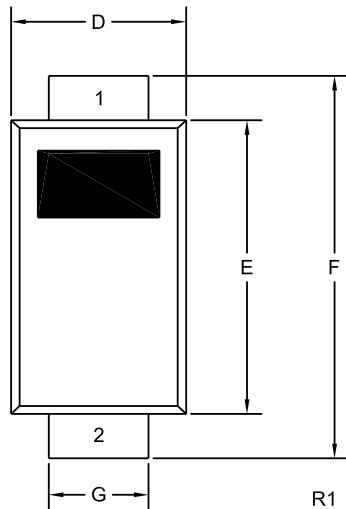

SYMBOL	DIMENSIONS			
	INCHES		MILLIMETERS	
	MIN	MAX	MIN	MAX
A	0.035	0.043	0.88	1.08
B	0.020	0.031	0.50	0.80
C	0.004	0.008	0.10	0.20
D	0.065	0.077	1.65	1.95
E	0.104	0.116	2.65	2.95
F	0.140	0.156	3.55	3.95
G	0.030	0.041	0.75	1.05

SOD-123F (REV:R1)

**LEAD CODE:**

- 1) Cathode
- 2) Anode

**MARKING CODES:**

DEVICE	CODE
CMMSH1-20	CS20F
CMMSH1-40	CS40F
CMMSH1-60	CS60F
CMMSH1-100	CS100F
CMMSH1-20G*	CS20G
CMMSH1-40G*	CS40G
CMMSH1-60G*	CS60G
CMMSH1-100G*	CS100G

\* Device is *Halogen Free* by design

R5 (25-January 2010)

# Mouser Electronics

Authorized Distributor

Click to View Pricing, Inventory, Delivery & Lifecycle Information:

[Central Semiconductor:](#)

[CMMSH1-100G TR PBFREE](#) [CMMSH1-20G TR PBFREE](#) [CMMSH1-40G TR PBFREE](#)