

Specifications (measured at $T_A = 25^\circ\text{C}$, nominal input voltage, full load and after warm-up)

Efficiency at Full Load	See Selection Guide		
Minimum Load = 0%	Specifications valid for 10% minimum load only.		
Isolation Voltage	(tested for 1 second) (rated for 1 minute***)	1000VDC 500VAC / 60Hz	
Isolation Voltage	H-Suffix (tested for 1 second) H-Suffix (rated for 1 minute***)	3000VDC 1500VAC / 60Hz	
Isolation Capacitance	R1S, R1S8, R1D, R1D10 R1S12, R1D12	15pF min. / 70pF max. 10pF min. / 75pF max.	
Isolation Resistance	10 G Ω min.		
Short Circuit Protection	1 Second		
P-Suffix	Continuous		
Operating Temperature Range (free air convection)	-40°C to +100°C (see Graph)		
Storage Temperature Range	-55°C to +125°C		
Reflow Temperature	ROHS compliant	245°C (30 sec), Peak 255°C (5 sec) max.	
Vapor Phase Process	(for more details see Application Notes)	230°C (90 sec) max.	
Relative Humidity	95% RH		
Humidity Susceptibility Test	1000 hrs / 90% humidity / +85°C ambient		
Package weight	R1S R1S8 R1S12, R1D, R1D10, R1D12	1.0g 1.1g 1.2g	
Packing Quantity	R1S, R1S8 R1S12, R1D, R1D10, R1D12 All Types	40 pcs per Tube 33 pcs per tube 500 pcs per Reel	
MTBF (+25°C) (+85°C)	} Detailed Information see Application Notes chapter "MTBF" using MIL-HDBK 217F	using MIL-HDBK 217F	4275 x 10 ³ hours
		using MIL-HDBK 217F	1365 x 10 ³ hours
Certifications			
CB Test Report	Report: US/14402A/UL	IEC 60950-1:2001 1st Ed.	
UL General Safety	Report: E358085	UL 60950-1 2nd Ed.	
CUL General Safety		C22.2 No. 60950-1-03	
EN Medical Safety	Report: MDD1205098-2 + RM1205098-2 Medical Report + ISO14971 Risk Assessment	IEC/EN 60601-1 3rd Edition	
EN General Safety	Report: SPCLVD1211033-3	EN60950-1: 2006 + A12:2011	
Conducted / Radiated Emissions	EN55022	Level A	

***Any data referred to in this datasheet are of indicative nature and based on our practical experience only. For further details, please refer to our Application Notes.

Notes

Note 1: Maximum capacitive load is defined as the capacitive load that will allow start up in under 1 second without damage to the converter.

Typical Characteristics

Tolerance Envelope

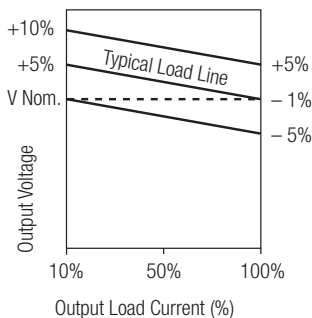

R1S**-xx05

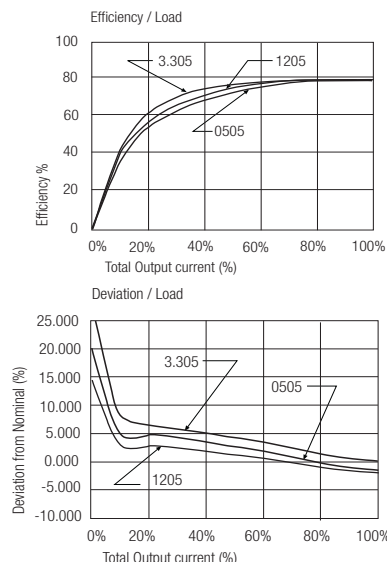

R1D**-xx05

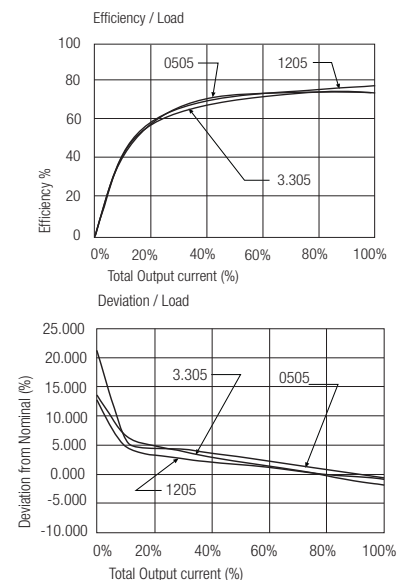

Package Style and Pinning (mm)

5 PIN Single SMD Package

Note: /H option is available in these pin packages

6 PIN Dual SMD Package

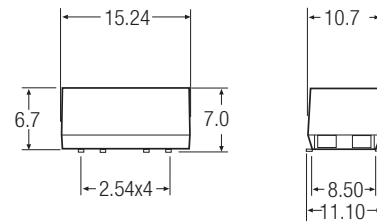
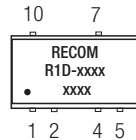
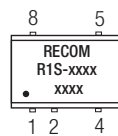
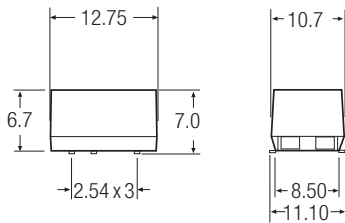

Recommended Footprint Details

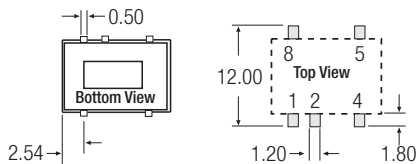

Pin Connections

Pin #	Single	Dual
1	-Vin	-Vin
2	+Vin	+Vin
4	-Vout	Com
5	+Vout	-Vout
7	No Pin	+Vout
8	NC	No Pin
10	No Pin	NC

NC = No Connection

XX.X ± 0.5 mm

XX.XX ± 0.25 mm

Recommended Footprint Details

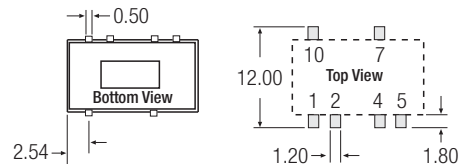

8 PIN Single SMD Package

Note: /H option is not available in these pin packages

10 PIN Dual SMD Package

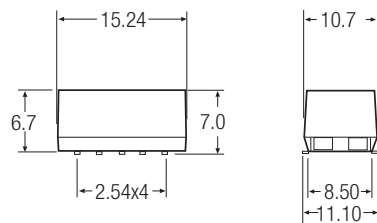
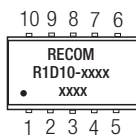
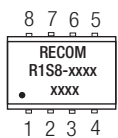
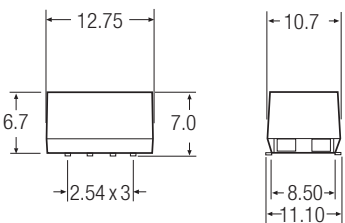

Recommended Footprint Details

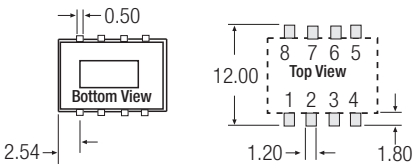

Pin Connections

Pin #	Single	Dual
1	-Vin	-Vin
2	+Vin	+Vin
3	NC	NC
4	-Vout	Com
5	+Vout	-Vout
6	NC	NC
7	NC	+Vout
8	NC	NC
9	-	NC
10	-	NC

NC = No Connection

XX.X ± 0.5 mm

XX.XX ± 0.25 mm

Recommended Footprint Details

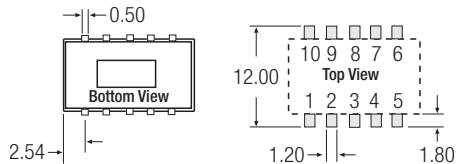

R1S** : ** without marking denotes 5 pins out of 8 fitted (includes /H option)
 ** with marking **8** denotes 8 pins out of 8 fitted (/H option not available)

e.g. R1S-0505, R1S-0505/H, R1S-0505/HP
 e.g. R1S8-0505, R1S8-0505/P

R1D** : ** without marking denotes 6 pins out of 10 fitted (includes /H option)
 ** with marking **10** denotes with 10 pins out of 10 fitted (/H option not available)

e.g. R1D-0505, R1D-0505/H, R1D-0505/HP
 e.g. R1D10-0505, R1D10-0505/P

Package Style and Pinning (mm)

12 PIN Single and Dual SMD Package

Note: /H option is available in this pin package

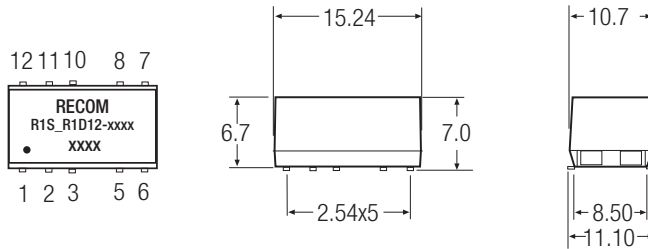

Pin Connections

Pin #	Single	Dual
1	-Vin	-Vin
2	+Vin	+Vin
3	NC	NC
5	-Vout	Com
6	NC	-Vout
7	NC	NC
8	+Vout	+Vout
10	NC	NC
11	NC	NC
12	NC	NC

NC = No Connection

XX.X ± 0.5 mm

XX.XX ± 0.25 mm

Recommended Footprint Details

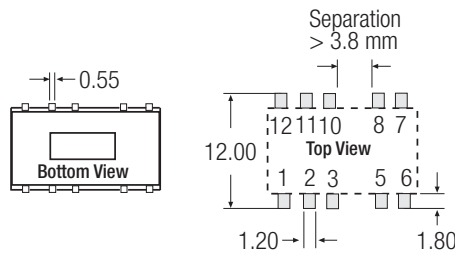

R1S** : ** with marking **12** denotes 10 pins out of 12 fitted (includes /H option)
 R1D** : ** with marking **12** denotes 10 pins out of 12 fitted (includes /H option)

e.g. R1S12-0505, R1S12-0505/H, R1S12-0505/HP
 e.g. R1D12-0505, R1D12-0505/H, R1D12-0505/HP

EMC Filtering - Suggestion for EN55022 Class B (Conducted and Emitted)

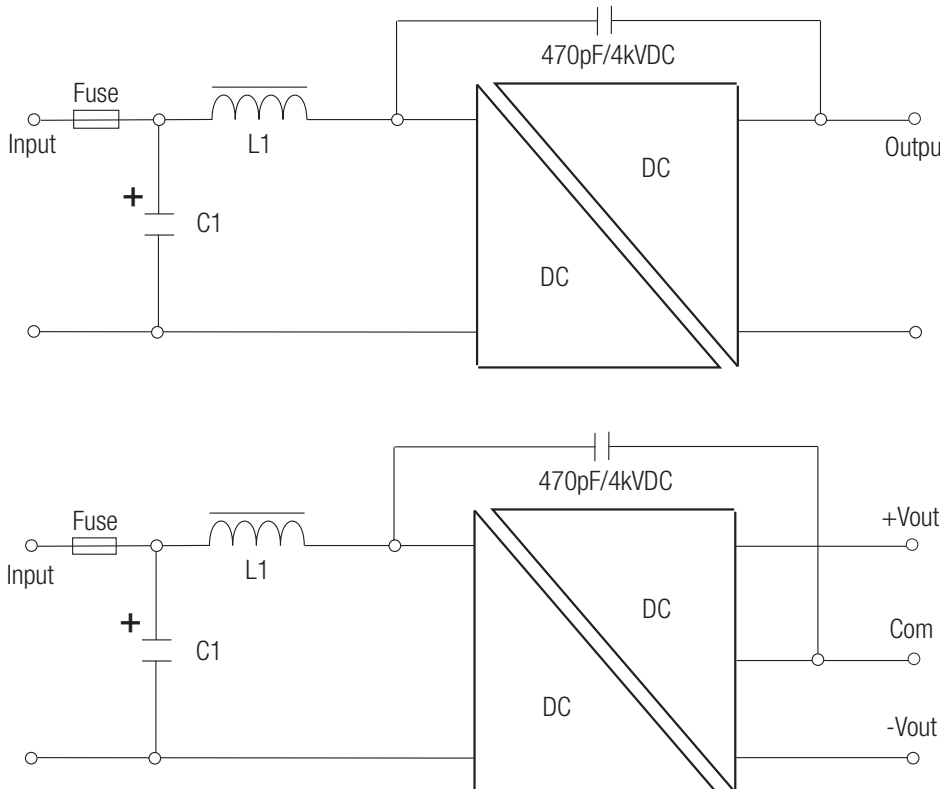

Standard and /H versions

C1	L1	Vin
4.7µF	3.3µH	3.3V
2.2µF	4.7µH	5V
2.2µF	10µH	12V
2.2µF	22µH	15V
4.7µF	22µH	24V

/P and /HP versions

C1	L1	Vin
4.7µF	10µH	3.3V
10µF	10µH	5V
4.7µF	22µH	12V
4.7µF	22µH	15V
10µF	47µH	24V

C1 = MLCC

L1 = SMD Inductor

The product information and specifications are subject to change without prior notice. RECOM products are not authorized for use in safety-critical applications (such as life support) without RECOM's explicit written consent. A safety-critical application is defined as an application where a failure of a RECOM product may reasonably be expected to endanger or cause loss of life, inflict bodily harm or damage property. The buyer shall indemnify and hold harmless RECOM, its affiliated companies and its representatives against any damage claims in connection with the unauthorized use of RECOM products in such safety-critical applications.

Mouser Electronics

Authorized Distributor

Click to View Pricing, Inventory, Delivery & Lifecycle Information:

RECOM:

[R1D-0505](#) [R1D-0512](#) [R1D-1205](#) [R1D-1212](#) [R1S-0505](#) [R1S-0512](#) [R1S-1205](#) [R1S-1212](#) [R1S8-0505](#) [R1D-0505/H](#)
[R1D-0505/HP](#) [R1D-0505/HP-R](#) [R1D-0505/H-R](#) [R1D-0505/P](#) [R1D-0505/P-R](#) [R1D-0505-R](#) [R1D-0509](#) [R1D-0509/H](#)
[R1D-0509/HP](#) [R1D-0509/HP-R](#) [R1D-0509/H-R](#) [R1D-0509/P](#) [R1D-0509/P-R](#) [R1D-0509-R](#) [R1D-0512/H](#) [R1D-](#)
[0512/HP](#) [R1D-0512/HP-R](#) [R1D-0512/H-R](#) [R1D-0512/P](#) [R1D-0512/P-R](#) [R1D-0512-R](#) [R1D-0515](#) [R1D-0515/H](#) [R1D-](#)
[0515/HP](#) [R1D-0515/HP-R](#) [R1D-0515/H-R](#) [R1D-0515/P](#) [R1D-0515/P-R](#) [R1D-0515-R](#) [R1D-0524](#) [R1D-0524/H](#) [R1D-](#)
[0524/HP](#) [R1D-0524/HP-R](#) [R1D-0524/H-R](#) [R1D-0524/P](#) [R1D-0524/P-R](#) [R1D-0524-R](#) [R1D-053.3](#) [R1D-053.3/H](#) [R1D-](#)
[053.3/HP](#) [R1D-053.3/HP-R](#) [R1D-053.3/H-R](#) [R1D-053.3/P](#) [R1D-053.3/P-R](#) [R1D-053.3-R](#) [R1D10-0505](#) [R1D10-](#)
[0505/P](#) [R1D10-0505/P-R](#) [R1D10-0505-R](#) [R1D10-0509](#) [R1D10-0509/P](#) [R1D10-0509/P-R](#) [R1D10-0509-R](#) [R1D10-](#)
[0512](#) [R1D10-0512/P](#) [R1D10-0512/P-R](#) [R1D10-0512-R](#) [R1D10-0515](#) [R1D10-0515/P](#) [R1D10-0515/P-R](#) [R1D10-0515-](#)
[R](#) [R1D10-0524](#) [R1D10-0524/P](#) [R1D10-0524/P-R](#) [R1D10-0524-R](#) [R1D10-053.3](#) [R1D10-053.3/P](#) [R1D10-053.3/P-R](#)
[R1D10-053.3-R](#) [R1D10-1205](#) [R1D10-1205/P](#) [R1D10-1205/P-R](#) [R1D10-1205-R](#) [R1D10-1209](#) [R1D10-1209/P](#)
[R1D10-1209/P-R](#) [R1D10-1209-R](#) [R1D10-1212](#) [R1D10-1212/P](#) [R1D10-1212/P-R](#) [R1D10-1212-R](#) [R1D10-1215](#)
[R1D10-1215/P](#) [R1D10-1215/P-R](#) [R1D10-1215-R](#) [R1D10-1224](#) [R1D10-1224/P](#) [R1D10-1224/P-R](#) [R1D10-1224-R](#)
[R1D10-123.3](#)