

ORDERING INFORMATION					
PART NO.	AEC-Q101 QUALIFIED	PACKING CODE	GREEN COMPOUND CODE	PACKAGE	PACKING
HS2xA (Note 1)	Prefix "H"	R3	Suffix "G"	SMA	1,800 / 7" Plastic reel
		R2		SMA	7,500 / 13" Paper reel
		M2		SMA	7,500 / 13" Plastic reel
		F3		Folded SMA	1,800 / 7" Plastic reel
		F2		Folded SMA	7,500 / 13" Paper reel
		F4		Folded SMA	7,500 / 13" Plastic reel
	N/A	E3		Clip SMA	1,800 / 7" Plastic reel
		E2		Clip SMA	7,500 / 13" Plastic reel

Note 1: "x" defines voltage from 50V (HS2AA) to 1000V (HS2MA)

EXAMPLE					
PREFERRED P/N	PART NO.	AEC-Q101 QUALIFIED	PACKING CODE	GREEN COMPOUND CODE	DESCRIPTION
HS2MA R3	HS2MA		R3		
HS2MA R3G	HS2MA		R3	G	Green compound
HS2MAHR3	HS2MA	H	R3		AEC-Q101 qualified

RATINGS AND CHARACTERISTICS CURVES

(TA=25°C unless otherwise noted)

FIG. 1 FORWARD CURRENT DERATING CURVE

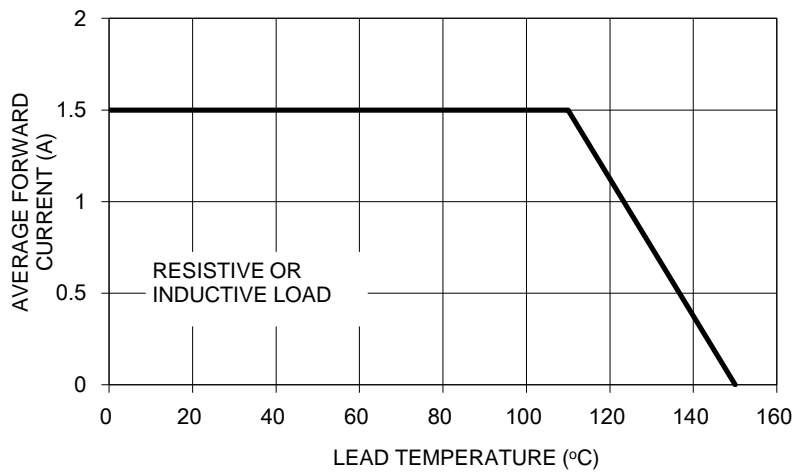

FIG. 2 TYPICAL REVERSE CHARACTERISTICS

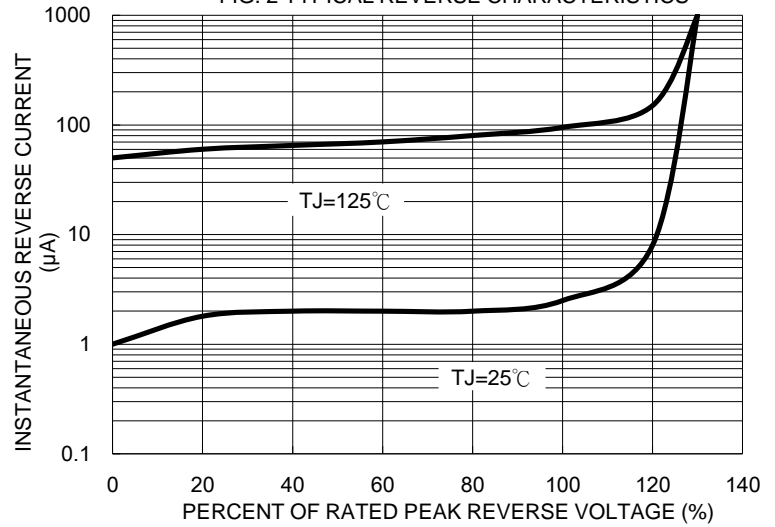

FIG. 3 MAXIMUM NON-REPETITIVE FORWARD SURGE CURRENT

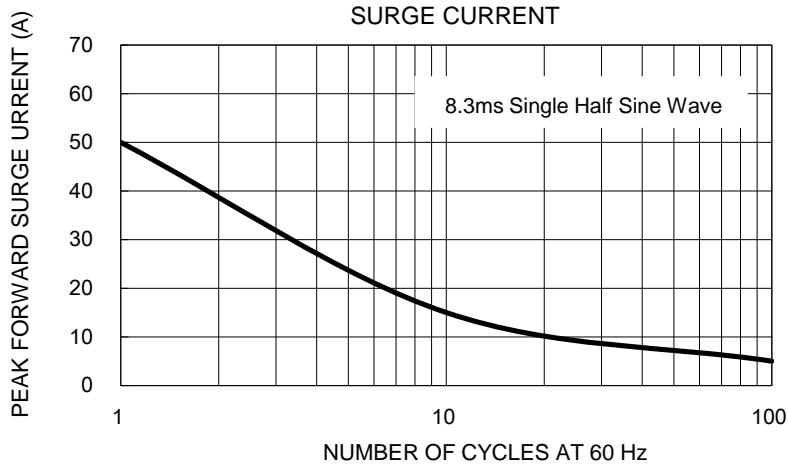

FIG. 4 TYPICAL FORWARD CHARACTERISTICS

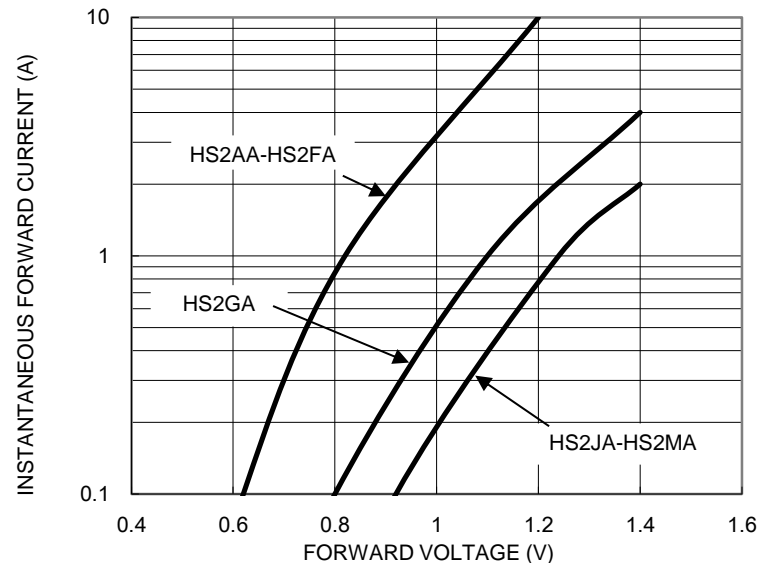

FIG. 5 TYPICAL JUNCTION CAPACITANCE

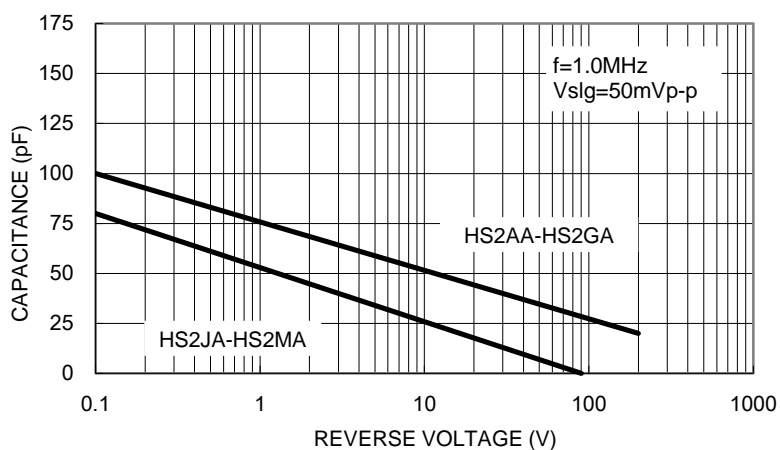
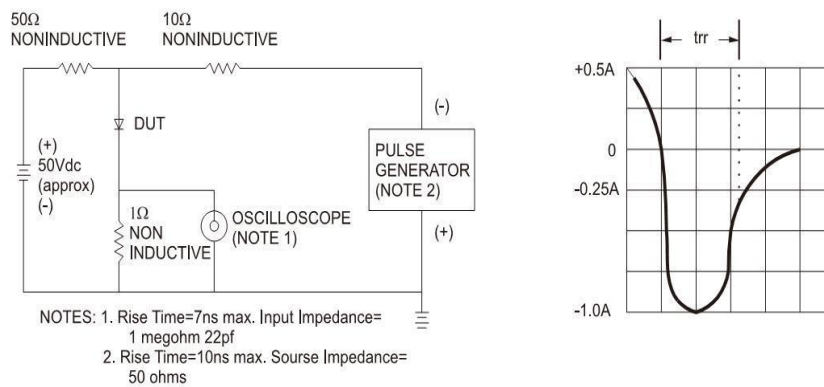
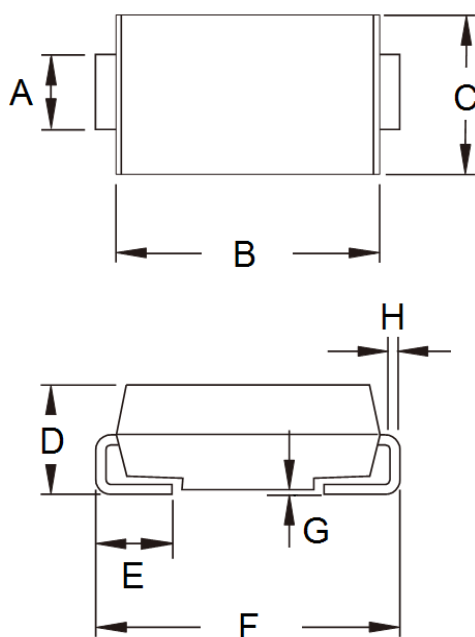

FIG.6- REVERSE RECOVERY TIME CHARACTERISTIC AND TEST CIRCUIT DIAGRAM



PACKAGE OUTLINE DIMENSIONS



DIM.	Unit (mm)		Unit (inch)	
	Min	Max	Min	Max
A	1.27	1.58	0.050	0.062
B	4.06	4.60	0.160	0.181
C	2.29	2.83	0.090	0.111
D	1.99	2.50	0.078	0.098
E	0.90	1.41	0.035	0.056
F	4.95	5.33	0.195	0.210
G	0.10	0.20	0.004	0.008
H	0.15	0.31	0.006	0.012

SUGGESTED PAD LAYOUT

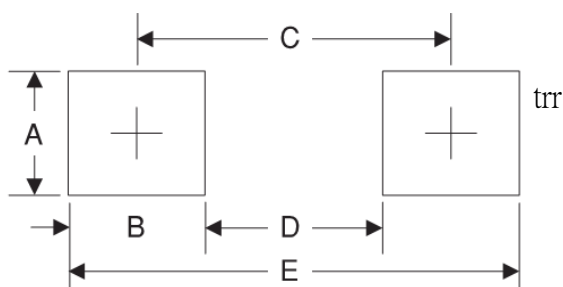

Symbol	Unit (mm)	Unit (inch)
A	1.68	0.066
B	1.52	0.060
C	3.93	0.155
D	2.41	0.095
E	5.45	0.215

MARKING DIAGRAM



- P/N = Specific Device Code
- G = Green Compound
- YW = Date Code
- F = Factory Code

Notice

Specifications of the products displayed herein are subject to change without notice. TSC or anyone on its behalf, assumes no responsibility or liability for any errors inaccuracies.

Information contained herein is intended to provide a product description only. No license, express or implied, to any intellectual property rights is granted by this document. Except as provided in TSC's terms and conditions of sale for such products, TSC assumes no liability whatsoever, and disclaims any express or implied warranty, relating to sale and/or use of TSC products including liability or warranties relating to fitness for a particular purpose, merchantability, or infringement of any patent, copyright, or other intellectual property right.

The products shown herein are not designed for use in medical, life-saving, or life-sustaining applications. Customers using or selling these products for use in such applications do so at their own risk and agree to fully indemnify TSC for any damages resulting from such improper use or sale.

Mouser Electronics

Authorized Distributor

Click to View Pricing, Inventory, Delivery & Lifecycle Information:

Taiwan Semiconductor:

[HS2AA](#) [HS2DA](#) [HS2FA](#) [HS2GA](#) [HS2KA](#) [HS2GAHF3G](#) [HS2MA F2](#) [HS2MA R2G](#) [HS2GA R2G](#) [HS2MAHR2G](#)
[HS2KAHF2G](#) [HS2MA R2](#) [HS2BA R3](#) [HS2MAHF3G](#) [HS2JA R2G](#) [HS2KA F2G](#) [HS2BAHF3G](#) [HS2FA F2G](#)
[HS2FAHR3G](#) [HS2KAHF3G](#) [HS2GA F2G](#) [HS2KAHR3G](#) [HS2BAHF2G](#) [HS2FA R2](#) [HS2MAHR3G](#) [HS2JAHR3G](#)
[HS2JA F2](#) [HS2DA R3](#) [HS2DA R2G](#) [HS2KA R2G](#) [HS2JA F2G](#) [HS2FAHR2G](#) [HS2GAHR2G](#) [HS2GA R2](#)
[HS2JAHR2G](#) [HS2FAHF2G](#) [HS2MA F2G](#) [HS2DA R2](#) [HS2GAHR3G](#) [HS2BA R2](#) [HS2BAHR2G](#) [HS2BAHR3G](#)
[HS2FA R2G](#) [HS2BA F2G](#) [HS2JAHF2G](#) [HS2DAH2G](#) [HS2JA R3](#) [HS2KA R3](#) [HS2FA R3](#) [HS2FAHF3G](#) [HS2JA R2](#)
[HS2MAHF2G](#) [HS2GA R3](#) [HS2KA R2](#) [HS2MA R3](#) [HS2GAHF2G](#) [HS2KAHR2G](#) [HS2DAH2G](#) [HS2DAH2G](#)
[HS2JAHF3G](#) [HS2DA F2G](#) [HS2DAHR3G](#) [HS2BA R2G](#) [HS2AA R2G](#) [HS2AAHR2G](#) [HS2AAHF3G](#) [HS2AAHR3G](#)
[HS2AA R3](#) [HS2AAHF2G](#) [HS2AA F2G](#) [HS2JAHM2G](#) [HS2BA M2G](#) [HS2BAHM2G](#) [HS2DA M2G](#) [HS2DAH2G](#)
[HS2FA M2G](#) [HS2FAHM2G](#) [HS2AA M2G](#) [HS2AAHM2G](#) [HS2KA M2G](#) [HS2KAHM2G](#) [HS2MAHM2G](#) [HS2GA M2G](#)
[HS2GAHM2G](#) [HS2JA M2G](#) [HS2BA](#) [HS2DAH](#) [HS2FAH](#) [HS2GAH](#) [HS2JAH](#) [HS2KAH](#) [HS2MAH](#)