

ORDERING INFORMATION					
PART NO.	AEC-Q101 QUALIFIED	PACKING CODE	GREEN COMPOUND CODE	PACKAGE	PACKING
ES2x (Note 1)	Prefix "H"	R5	Suffix "G"	SMB	850 / 7" Plastic reel
		R4		SMB	3,000 / 13" Paper reel
		M4		SMB	3,000 / 13" Plastic reel

Note 1: "xx" defines voltage from 50V (ES2A) to 600V (ES2J)

EXAMPLE					
PREFERRED P/N	PART NO.	AEC-Q101 QUALIFIED	PACKING CODE	GREEN COMPOUND CODE	DESCRIPTION
ES2J R5	ES2J		R5		
ES2J R5G	ES2J		R5	G	Green compound
ES2JHR5	ES2J	H	R5		AEC-Q101 qualified

RATINGS AND CHARACTERISTICS CURVES

(TA=25°C unless otherwise noted)

FIG. 1- MAXIMUM FORWARD CURRENT DERATING CURVE

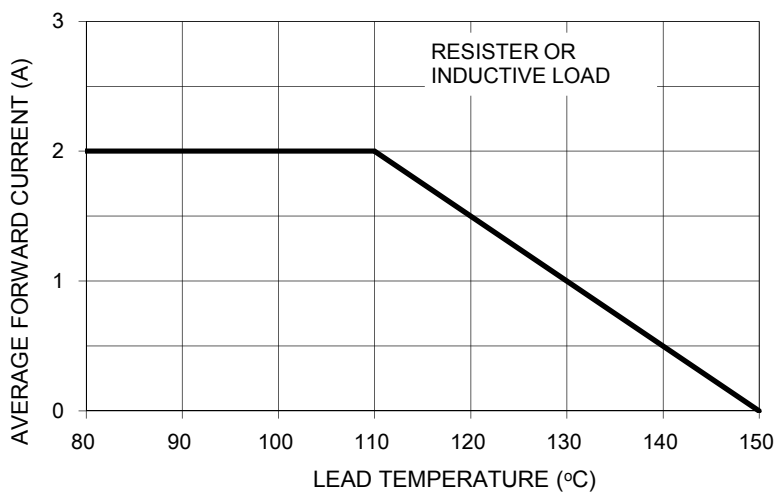

FIG. 2- TYPICAL REVERSE CHARACTERISTICS

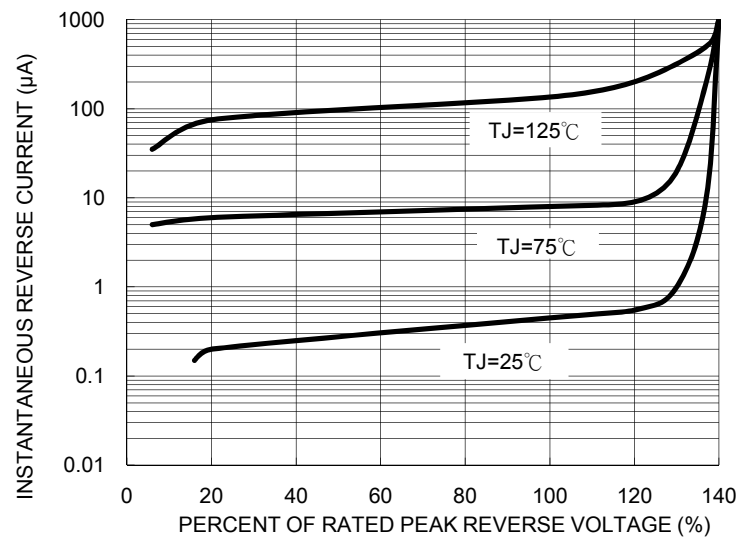

FIG. 3- MAXIMUM NON-REPETITIVE PEAK FORWARD SURGE CURRENT

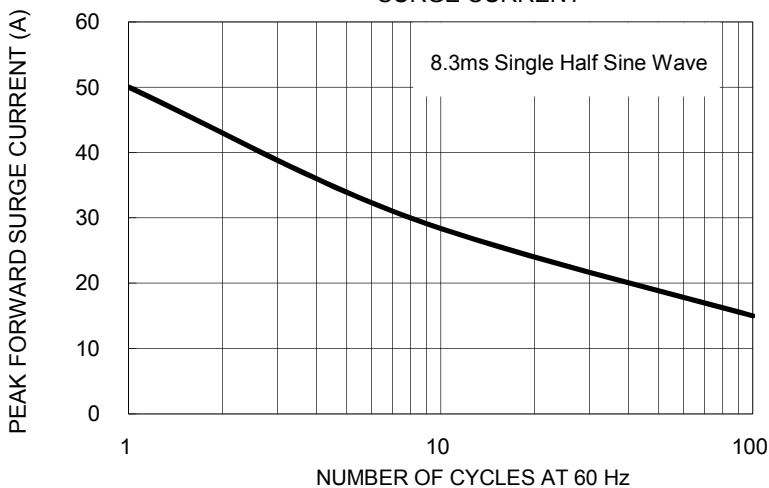

FIG. 4- TYPICAL INSTANTANEOUS FORWARD CHARACTERISTICS

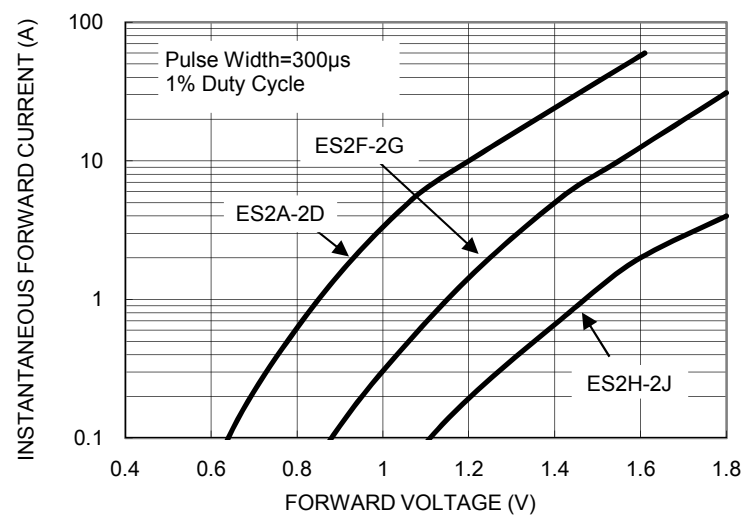

FIG. 5- TYPICAL JUNCTION CAPACITANCE

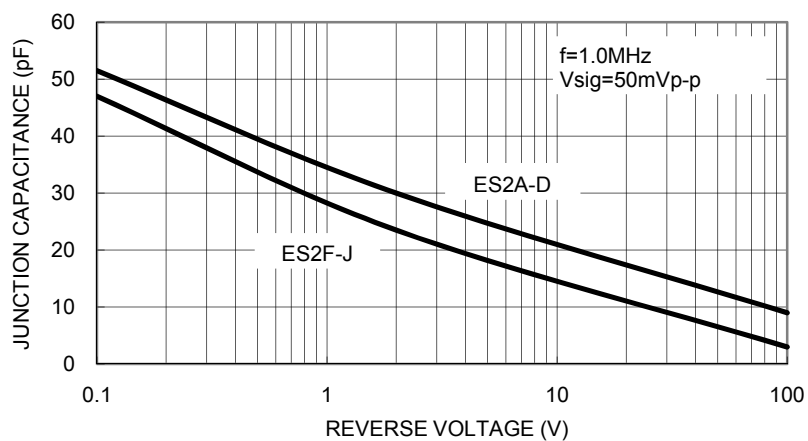
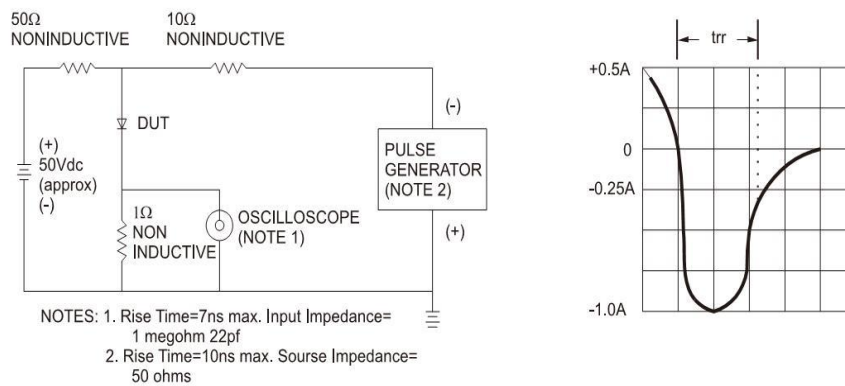
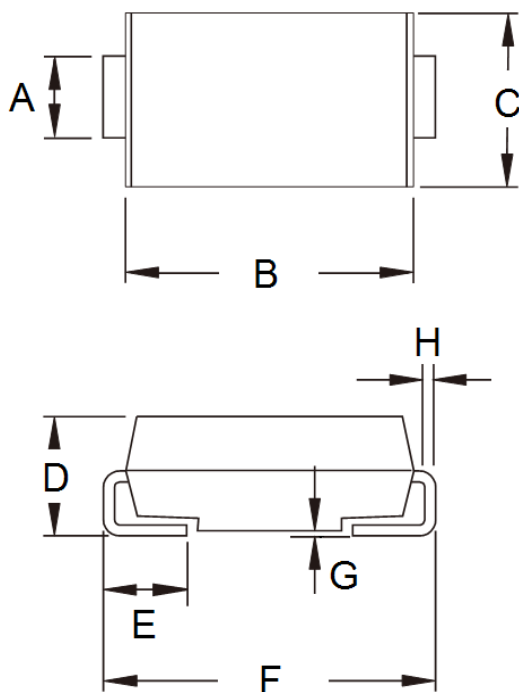

FIG.6- REVERSE RECOVERY TIME CHARACTERISTIC AND TEST CIRCUIT DIAGRAM



PACKAGE OUTLINE DIMENSIONS



DIM.	Unit (mm)		Unit (inch)	
	Min	Max	Min	Max
A	1.95	2.10	0.077	0.083
B	4.25	4.75	0.167	0.187
C	3.48	3.73	0.137	0.147
D	1.99	2.61	0.078	0.103
E	0.90	1.41	0.035	0.056
F	5.10	5.30	0.201	0.209
G	0.10	0.20	0.004	0.008
H	0.15	0.31	0.006	0.012

SUGGESTED PAD LAYOUT

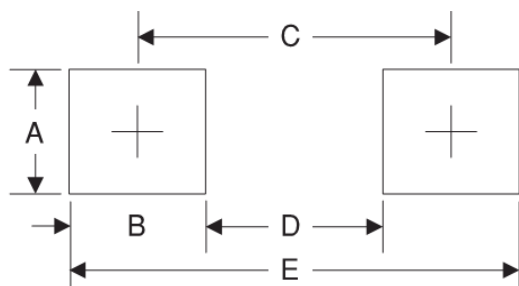

Symbol	Unit (mm)	Unit (inch)
A	2.3	0.091
B	2.5	0.098
C	4.3	0.169
D	1.8	0.071
E	6.8	0.268

MARKING DIAGRAM



- P/N = Specific Device Code
- G = Green Compound
- YW = Date Code
- F = Factory Code

Notice

Specifications of the products displayed herein are subject to change without notice. TSC or anyone on its behalf, assumes no responsibility or liability for any errors inaccuracies.

Information contained herein is intended to provide a product description only. No license, express or implied, to any intellectual property rights is granted by this document. Except as provided in TSC's terms and conditions of sale for such products, TSC assumes no liability whatsoever, and disclaims any express or implied warranty, relating to sale and/or use of TSC products including liability or warranties relating to fitness for a particular purpose, merchantability, or infringement of any patent, copyright, or other intellectual property right.

The products shown herein are not designed for use in medical, life-saving, or life-sustaining applications. Customers using or selling these products for use in such applications do so at their own risk and agree to fully indemnify TSC for any damages resulting from such improper use or sale.

Mouser Electronics

Authorized Distributor

Click to View Pricing, Inventory, Delivery & Lifecycle Information:

Taiwan Semiconductor:

[ES2H R5](#) [ES2D R5G](#) [ES2D R4G](#) [ES2A R5](#) [ES2J R5G](#) [ES2GHR4](#) [ES2G R4G](#) [ES2F R5G](#) [ES2JHR4](#) [ES2BHR5](#)
[ES2FHR4](#) [ES2AHR5](#) [ES2HHR5](#) [ES2A R4G](#) [ES2J R4G](#) [ES2A R5G](#) [ES2JHR5](#) [ES2DHR5](#) [ES2B R4G](#) [ES2G R5G](#)
[ES2C R5G](#) [ES2BHR4](#) [ES2H R5G](#) [ES2DHR4](#) [ES2C R4G](#) [ES2CHR5](#) [ES2AHR4](#) [ES2GHR5](#) [ES2CHR4](#) [ES2D R4](#)
[ES2FHR5](#) [ES2HHR4](#) [ES2B R5G](#) [ES2F R4G](#) [ES2G R5](#) [ES2D R5](#) [ES2F R5](#) [ES2J R5](#) [ES2B M4G](#) [ES2D M4G](#)
[ES2A M4G](#) [ES2C M4G](#) [ES2G M4G](#) [ES2F M4G](#) [ES2H M4G](#) [ES2J M4G](#)